

Pocket BVM

The smallest foldable Resuscitator



The *Pocket BVM*

Resuscitator for manual pulmonary resuscitation and emergency respiratory support of adult patients.

Unpacking the Pocket BVM:

1. Separate the Face Mask from the folded Resuscitator Bag.
2. Fully expand the Resuscitator Bag from its folded position by pulling both end valves (Front patient valve housing (air/O₂ exit port) and rear air/O₂ inlet valve) outwards (in opposite directions) while twisting the Patient Valve. **Caution:** Do not pull the O₂ Reservoir Bag, tearing may occur!
3. Attach the Face Mask to the Patient Valve housing.

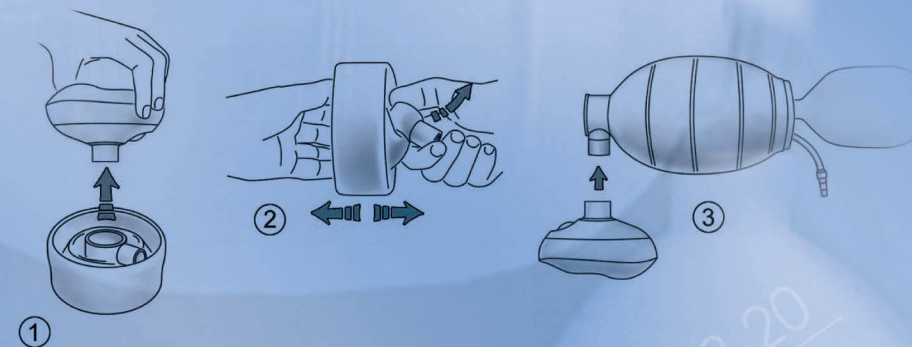

SPECIFICATIONS:

The body mass range for which the resuscitator is suitable for use	>40 kg (88 lbs.)
Stroke volume:	one hand 800ml, two hands 1400 ml
Resuscitator volume:	1600
Dead space	<6 ml
Expiratory resistance	3.4 cm H ₂ O
Inspiratory resistance	-4.5 cm H ₂ O
Delivered oxygen concentrations under various test conditions	55% (at 2 L/min) to 100% (at 8 L/min)
External dimensions of the resuscitator	217 mm (length) x 121 mm (diameter)
External dimensions of resuscitator in case	63 mm (height) x 134 mm (diameter)
Mass of the resuscitator, face mask and the resuscitator case.	Resuscitator 273 g Case. 90 g, Mask 87 g, Total 450 g
Bag reservoir volume	2600
Gas inlet tube connection	15mm length x 6mm O.D.
Patient connector:	Outside: 22 mm male (ANSI/ISO) Inside: 15 mm female (ANSI/ISO)
Expiratory connector (for PEEP valve attachment)	30 mm male (ISO)
Recommended operating temperature:	0°F to +122°F (-18°C to +50°C)
Recommended Storage temperature:	Tested at -40°F and +140°F (-40°C and + 60°C) according to EN ISO 10651-4:2002

